

eMotimo Belt Drive from Rhino Assembly Instructions

- ① Rhino Slider Pro
- ② Belt Mounting Plate
- ③ Idler Pulley
- ④ Mounting Screw #1
- ⑤ Mounting Screw #2
- ⑥ Drive Motor
- ⑦ Belt
- ⑧ eMotimo TB3
- ⑨ Motor Cable

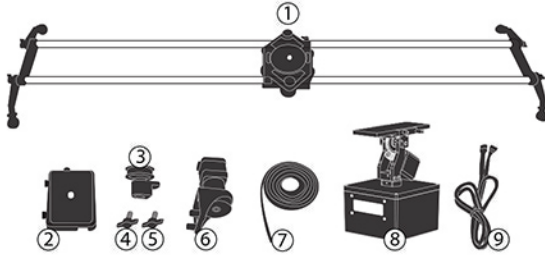

Step #1

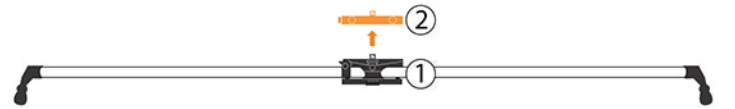

Mount the Belt Mounting Plate to the Rhino Slider Pro carriage by using the 3/8 -16 screw.

**Tip: Make sure this is tight so that it can't rotate.*

Step #2

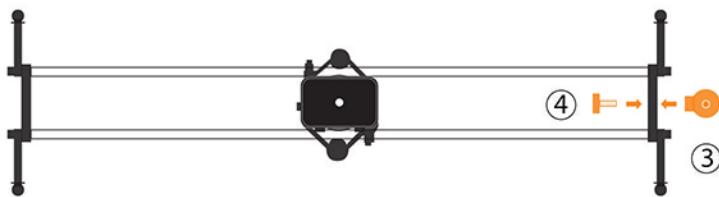

Mount the Idler Pulley to the Rhino Slider Pro rail bracket by using Mounting Screw #1.

Step #3

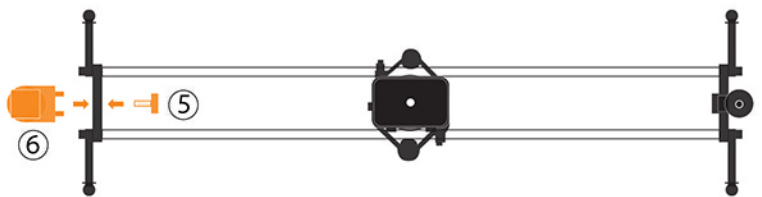

Mount the Drive Motor to the Rhino Slider Pro rail bracket (opposing side of step #2) by using Mounting Screw #2.

Step #4

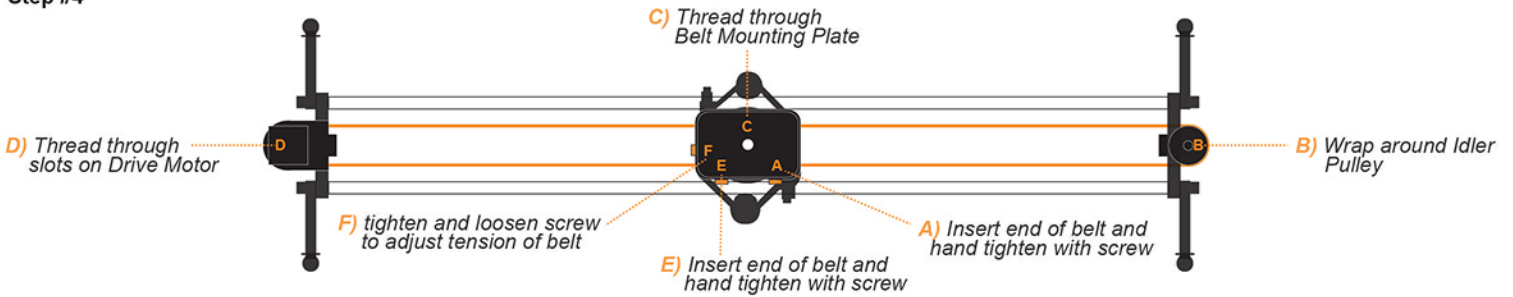

**Tip: Make sure all thumb screws are loose before starting steps a-f*

Step #5

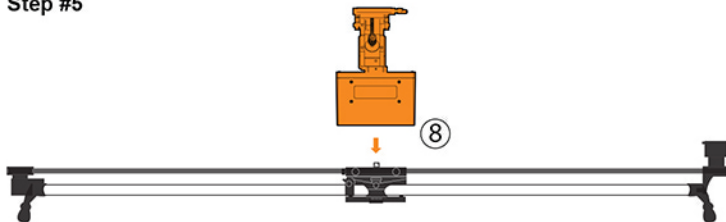

Mount the TB3 to the Belt Mounting Plate by using the 3/8 -16 screw

Step #6

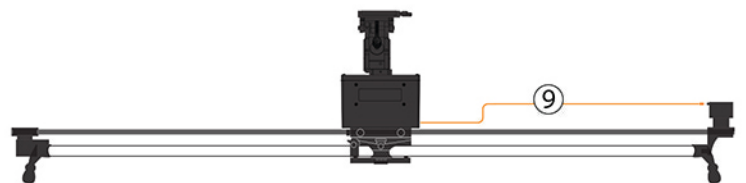

Attach Motor Cable to the TB3's AUX port and the Drive Motor.